

# SOL BAY

READY TO BE YOUR NEW ADDRESS





# About SOL Properties

**It's easy to build trust, when you have 45+ years of expertise.**

SOL Properties is the real estate arm of the Bhatia Group. Founded in 1975, it is an integrated property development company headquartered in Dubai, United Arab Emirates.

SOL, means the Sun. So, instinctively our core belief is to breathe life into cities via state-of-the-art infrastructure and architecture. We strive to create environments that promote healthy living and meet the needs of our residents. Our rigorous planning and quality of workmanship sets us apart as a visionary and customer-focused developer.

We've successfully completed more than 250 developments, including Hospitality, Residential, Industrial, Retail/Commercial sectors and government projects across Dubai.

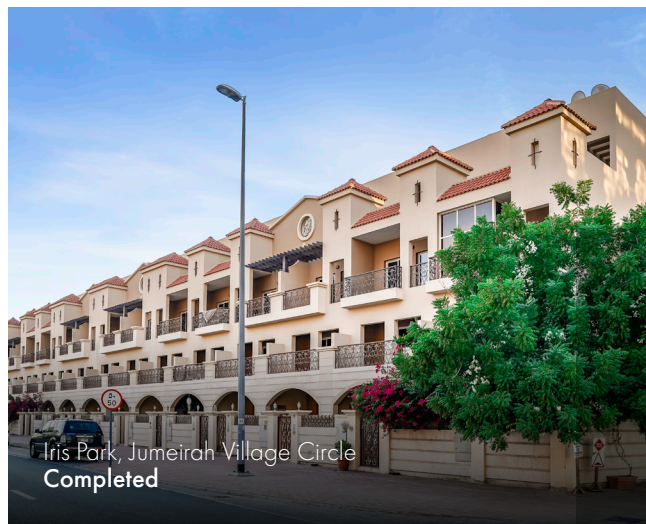





# SOL BAY

---

## **Ready to move in homes.**

The SOL BAY tower brings together inspiring design and luxury to create a world of convenience around you.

Set amidst the skyline of Dubai, this 19-storey opulent tower in Business Bay offers Studio, 1 bedroom and 2 bedroom apartments. It combines residences with a few commercial and retail spaces, and offers spectacular panoramic views of the Burj Khalifa.

Making SOL BAY your address means living a life in contemporary splendour, surrounded by detailed craftsmanship, smart spaces and best-in-class amenities. Be it indoors or outdoors, you'll enjoy luxury all along with high-end retail outlets and restaurants located on the ground floor, a fully equipped gymnasium and an extensive swimming pool that complements your elevated lifestyle.

This urban oasis in the heart of Dubai is SOL's finest offering for the discerning luxury residence buyer. We don't just say this, we can prove it too. Walk-in today to get a glimpse of our fully-ready apartments, amenities and facilities. And when you're ready, just move in!

# The land of living dreams

At a glance, Dubai, the city of gold, leaves you starry-eyed. Dubai is home to some of the world's most magnificent architecture, a global business hub and a well-diversified economy. Its beautiful habitat, world-class lifestyle and amenities has drawn thousands of expats, making it one of the world's top 10 best cities to live in.

A prime location in Dubai, Business Bay, has evolved into a neighbourhood of finely tailored residential area geared towards the upper crust. It plays host to an impressive line-up of hotels, fine-dining restaurants and luxury brands. Furthermore, the proximity and splendid views of the Burj Khalifa add a sense of grandeur to the environment.

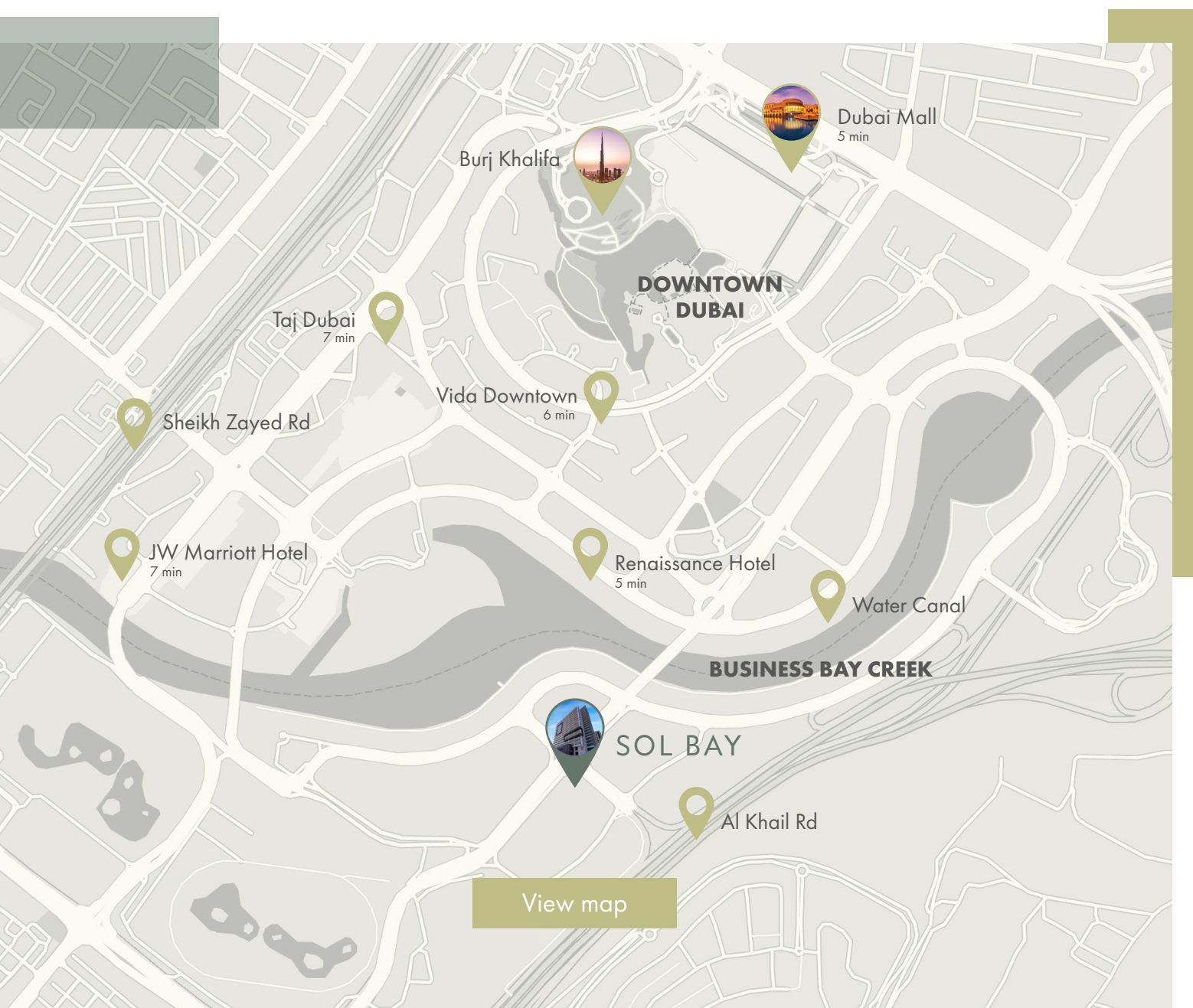



# SOL BAY, the desirable address that it is.

SOL BAY is set in a location where both, extravagance and convenience is but a stone's throw away. It is parallel to the lavish Downtown and Mohamed Bin Rashid City. It also enjoys the advantage of being close to the International Airport.

At SOL BAY, your every need is a quick stroll or drive away. From international schools and hospitals to top hotels and the world-famous Dubai Mall, all happen to be just around the corner. With breathtaking views of the Burj Khalifa, rest assured we've saved the best spot for you.

**Burj Khalifa**  
5 minute drive 

The kind of views that could inspire  
the photographer in you.





# Get spoiled, the SOL BAY way

Take a well-deserved break from the fast-paced urban life with aesthetically pleasing, private recreation spaces at the SOL BAY Tower.



## Deck pool

Gift yourself the most advanced from of wellness and unwind in a lavish swimming pool with a view of the city skyline or soak up the sun on the podium level.

## Gymnasium

Keep enjoying the pleasures of upscale leisure with a state-of-the-art gymnasium equipped with the latest machines, weights and other facilities.

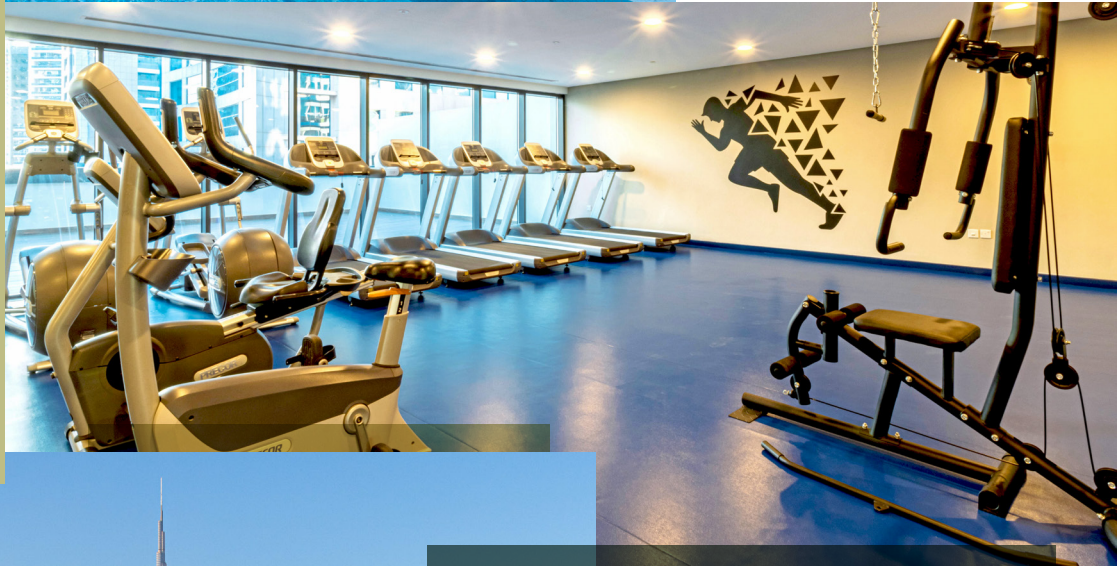

## Panoramic views of the Burj Khalifa and Dubai skyline

The SOL BAY residences boasts of exquisitely landscaped leisure decks unveiling a picturesque backdrop for your parties and a breathtaking view to come home to.







Immerse yourself in the flamboyance of the elegantly laid spaces. Our apartments are thoughtfully designed to maximize space, light and views. Every room is flooded with natural daylight and provides exceptional views through the full-height window walls, making you feel like you are part of Dubai's iconic landscape.





# Luxury apartments that exude opulence

Every detail has been thought of.  
Designed with function.  
Executed using the best materials.  
By the best teams.  
To ensure a comfortable and elevating living experience.





# Studio Furniture Layout

44m<sup>2</sup> + Balcony 6.8m<sup>2</sup> Total Area 50.8m<sup>2</sup>

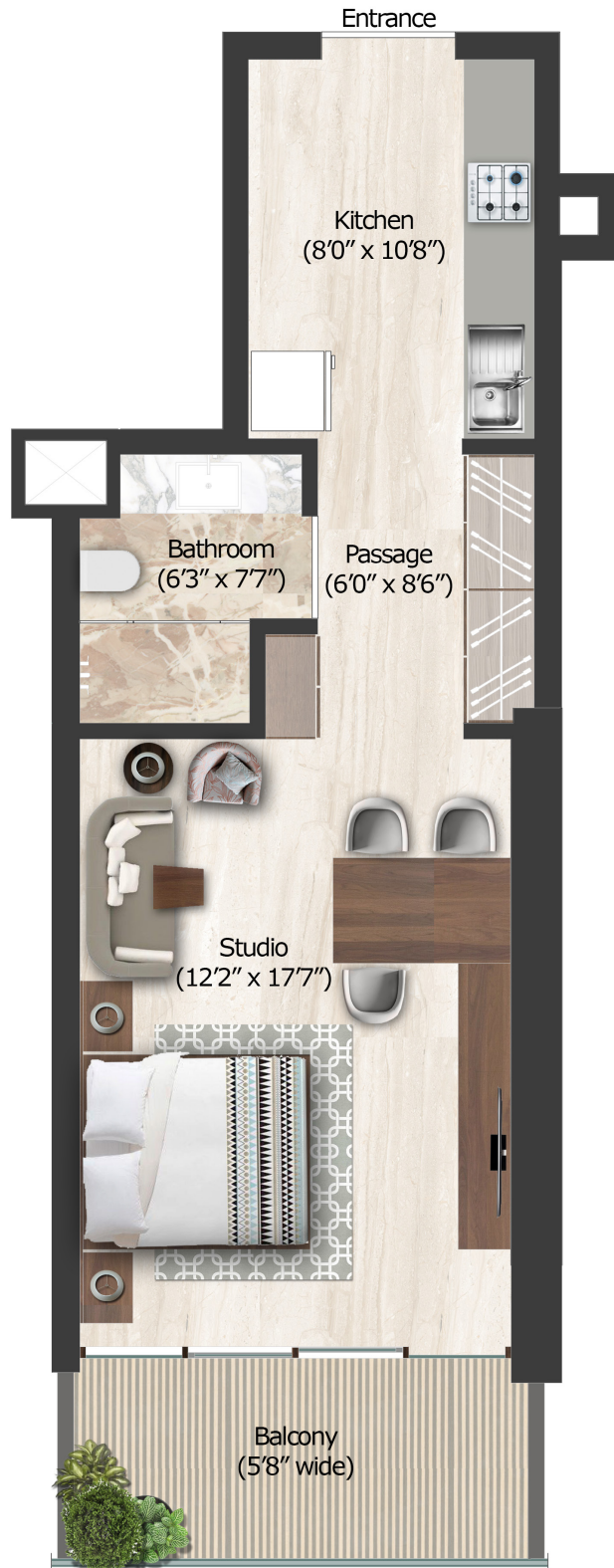



# 1 Bedroom Type A Furniture Layout

67m<sup>2</sup> + Balcony 13.65m<sup>2</sup> Total Area 80.65m<sup>2</sup>





# 1 Bedroom Type B Furniture Layout

80m<sup>2</sup> + Balcony 11.78m<sup>2</sup> Total Area 91.78m<sup>2</sup>





# 1 Bedroom Type C Furniture Layout

69m<sup>2</sup> + Balcony 13.65m<sup>2</sup> Total Area 82.65m<sup>2</sup>





# 1 Bedroom Type D Furniture Layout

78m<sup>2</sup> + Balcony 13.65m<sup>2</sup> Total Area 91.65m<sup>2</sup>



# 2 Bedroom Furniture Layout

115m<sup>2</sup> + Balcony 21.52m<sup>2</sup> Total Area 136.52m<sup>2</sup>





Get in touch

SOL